

MÜLLER x CITIZEN

Partnership // Technology // Range



Discover high-efficiency high-pressure systems and chip conveyors for Cincom long-turning and Miyano short-turning lathes



müller
efficiency matters

Maximum compatibility and system partnership

Benefit from unparalleled comfort, simplicity, efficiency, and smoothness through our system partnership. Everything is perfectly aligned and seamlessly integrates.

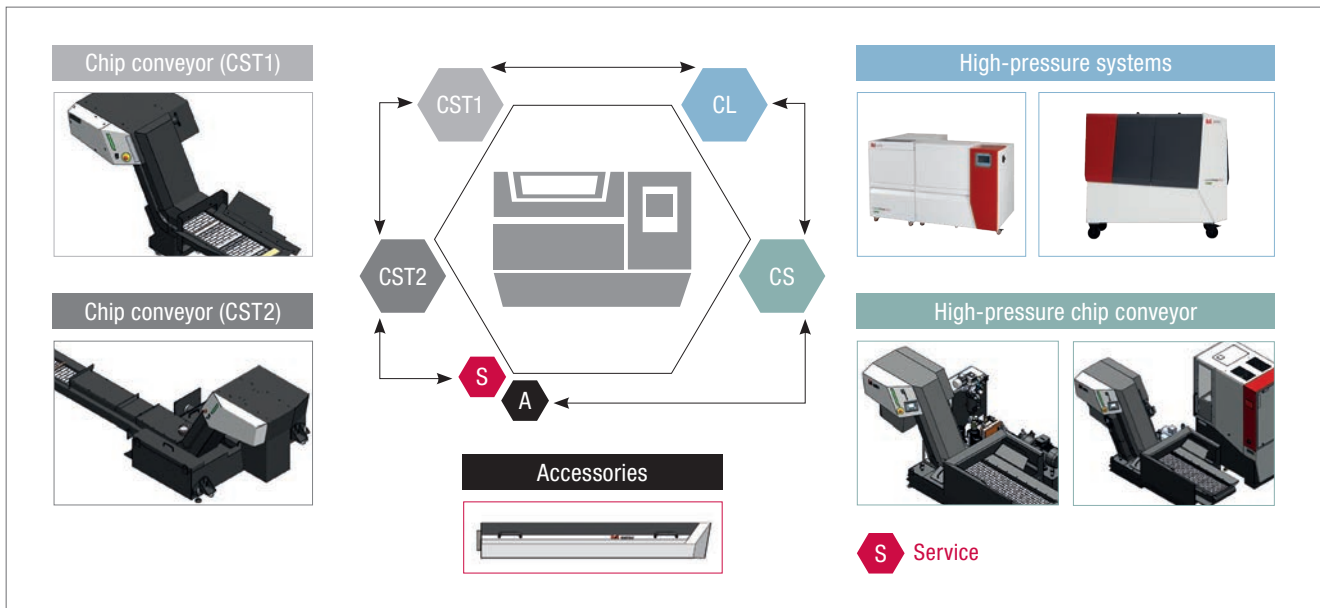

Müller x Citizen represents development standards and unique customization options through a sophisticated modular system. This collaboration ensures precise adaptation of high-pressure systems to lathes, offering significant benefits in connectivity, operation and service.

~3h

for connection and
commissioning incl.
hose packages

15%

faster training
thanks to
standardization

+20%

efficiency with
a precise interface
fit

i4.0

Surveillance sensors,
tele-assistance and
remote maintenance-
ready

Maximize your efficiency and save thousands of euros in minutes!

Discover the Müller Configurator now: in just 12 easy steps to the perfect high-pressure system for your lathe. End oversizing and efficiency losses!

Use our innovative configurator to enhance your machine tools' performance by thousands of euros. Simple, fast, and precise - tailored specifically to your needs.

For the best machine configuration, scan the QR code and configure your optimal solution now!



Chip conveyors: Range and technical data

Chip conveyor
chipstream CST1



Chip conveyor with additional tank
chipstream CST2

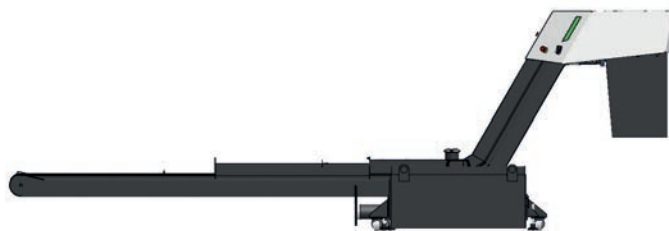

High-pressure chip conveyor
combistream CS3

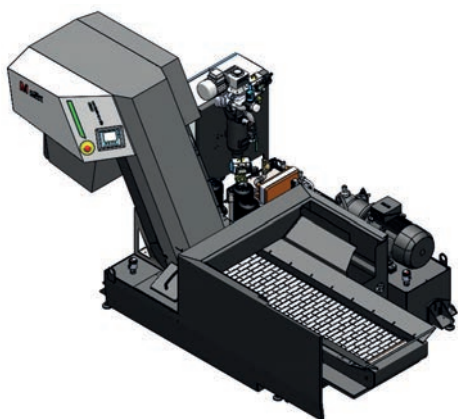

High-pressure chip conveyor with full-flow filtration
combistream CS4

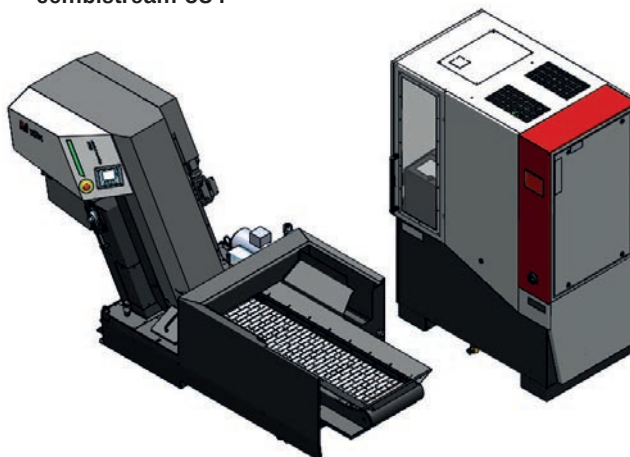

BK10 / BK11

BK20

BK30 / BK31

*BK11 / BK31: Scraper belt conveyor (not shown) instead of the hinged belt conveyor

	BK10	BK11	BK20	BK30	BK31
Function	Hinge belt conveyor with slot/plate division	Scraper conveyor with 500 µm pre-separation	Dual conveyor with 500 (300) µm pre-separation and automatic discharge	Hinge belt conveyor with slot/plate division and bottom cleaning of the machine tank	Scraper conveyor with 500 µm pre-separation and bottom cleaning of the machine tank
Construction	Configuration as a standard insert conveyor CST1 or in combination with CST2 or CS3	Configuration as a standard insert conveyor CST1 or in combination with CST2 or CS3	Pre-tank + Combo BK10 + Gap sieve 300 - 500 µm with discharge via dual conveyor	Replace machine tank; achieve maximum machine cleanliness via workspace conveyor and bottom cleaning	Replace machine tank; achieve maximum machine cleanliness via workspace conveyor and bottom cleaning
Application	Up to 30% fine chips max. (not recommended for brass, aluminium)	Fine chips only, max. 3-4 mm Ø roughing/rough machining. All materials.	Mixed chips: all chip types, all materials	Mixed chips: all chip types, all materials	Fine chips only, max. 3-4 mm Ø roughing/rough machining. All materials.

Citizen machine allocation

chipstream CST1	L12	B12E	B16E	D25	A20	L20	L32	M16	M32	BNA	BND	BNE	BNJ	ANX	ABX
BK10						●									
BK11						●									
Frequency-directed belt control						●									
chipstream CST2	L12	B12E	B16E	D25	A20	L20	L32	M16	M32	BNA	BND	BNE	BNJ	ANX	ABX
BK10								●						●	
BK11															
BK20														●	
Integrated low-pressure supply															
Frequency-directed belt control								●						●	
Additional tank (as machine or pre-tank)								●						●	
combistream CS3	L12	B12E	B16E	D25	A20	L20	L32	M16	M32	BNA	BND	BNE	BNJ	ANX	ABX
BK10				●	●	●	●	●	●						
BK11					●	●									
BK20										●		●	●	●	
BK30 + self-cleaning low-pressure intake protection				●	●	●	●	●	●						
BK31 + self-cleaning low-pressure intake protection					●	●									
Integrated high-pressure supply				●	●	●	●	●	●	●		●	●	●	
Long parts version					●	●	●	●	●						
Integrated low-pressure supply				●	●	●	●	●	●	●		●	●	●	
Additional tank (as machine or pre-tank)				●	●	●	●	●	●	●		●	●	●	
eco+ maximum energy efficiency				●	●	●	●	●	●	●		●	●	●	
Plate heat exchanger				●	●	●	●	●	●	●		●	●	●	
combistream CS4	L12	B12E	B16E	D25	A20	L20	L32	M16	M32	BNA	BND	BNE	BNJ	ANX	ABX
BK20														●	
BK30	●			●	●	●	●		●						
BK31					●	●	●								
Long parts version							●								
Integrated full-flow filtration	●			●	●	●	●		●					●	
Integrated high-pressure supply	●			●	●	●	●		●					●	
Integrated low-pressure supply	●			●	●	●	●		●					●	
Additional tank (as machine or pre-tank)	●			●	●	●	●		●					●	
eco+ maximum energy efficiency	●			●	●	●	●		●					●	
Plate heat exchanger	●			●	●	●	●		●					●	
Active cooler	●			●	●	●	●		●					●	

High-pressure systems: Range and technical specifications

	CL1	CL2	CL3	CL4
Particularly tight installation spaces 	 	 	 	
Standard installation 	 	 	 	 

	CL1B	CL1G	CL1E	CL2G	CL2E	CL3G	CL3E	CL4G
Washable exchange filter up to 25 µm	•	•	•	•	•	•	•	•
Twin coupling filter washable as exchange filter up to 25 µm	•		•	•	•	•	•	•
Washable cascade filter up to 25 µm						•		•
Automatic filter up to 30 µm						•	•	•
Pure high-pressure filtration	•	•	•	•	•	•	•	•
High-pressure and bypass filtration						•	•	•
Full-flow filtration								•
Up to 4 controllable service connections		•	•					
Up to 8 controllable service connections				•	•		•	
Up to 12 controllable service connections						•		•
High-pressure up to 24 l/min	•	•	•	•	•	•	•	•
High-pressure up to 30 l/min	•					•	•	
High-pressure up to 50 l/min	•					•		•
High-pressure up to 25 bar	•	•	•	•	•	•	•	•
High-pressure up to 70 bar		•	•	•	•	•	•	•
High-pressure up to 100 bar				•	•	•	•	•
High-pressure up to 150 bar						•	•	•
High-pressure up to 300 bar						•	•	•
Integrated tank up to 50 litres					•			
Integrated tank up to 200 litres				•			•	
Integrated tank up to 300 litres						•		
Integrated tank up to 800 litres								•
Under bar feeder positioning			•		•		•	
eco+ maximum energy efficiency			•	•	•	•	•	•
Plate heat exchanger (for external cooling source connection)						•	•	•
Compact active cooler (5.5 / 7.5 / 12.0 kW)								•

M

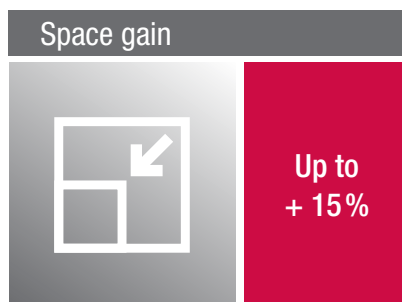
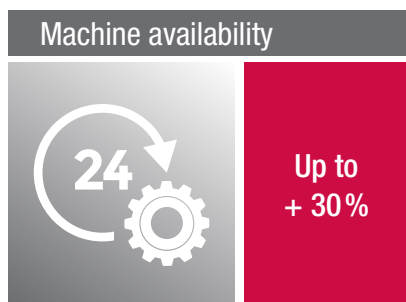
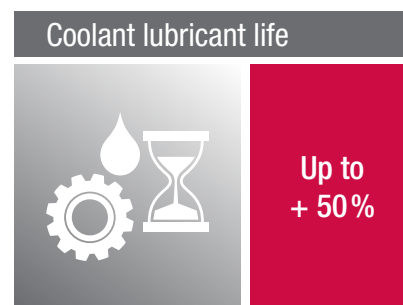
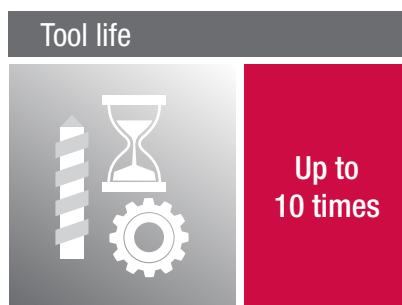
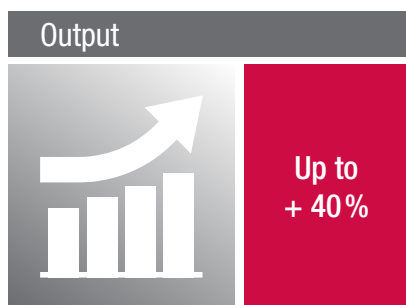

For more information on our benefits, please visit www.muellerhydraulik.de/en or scan the QR code.

Müller x Citizen – Contact



Müller Hydraulik GmbH
Albring 29
D-78658 Zimmern o. R.
Phone +49 (0)741 / 174 575-0
Fax +49 (0)741 / 174 575-299
sales@muellerhydraulik.de

HELP-DESK

Our help desk will be happy to assist you with support and service enquiries.

Phone +49 (0)741 / 174 575-121
service@muellerhydraulik.de

TICKET-SYSTEM

You can use our ticket system to report your service case online.

For this, please scan the QR code.



CITIZEN

Citizen Machinery Europe GmbH
Mettinger Str. 11
73728 Esslingen am Neckar
Phone +49 (0)711 / 3906-100
Fax +49 (0)711 / 3906-106
cme@citizen.de

