

MÜLLER x STAR MICRONICS

Partnership // Technology // Range

Discover high-efficiency high-pressure systems and chip conveyors for CNC automatic lathes from STAR Micronics



müller
efficiency matters

Maximum compatibility and system partnership

Benefit from unparalleled comfort, simplicity, efficiency, and smoothness through our system partnership. Everything is perfectly aligned and seamlessly integrates.

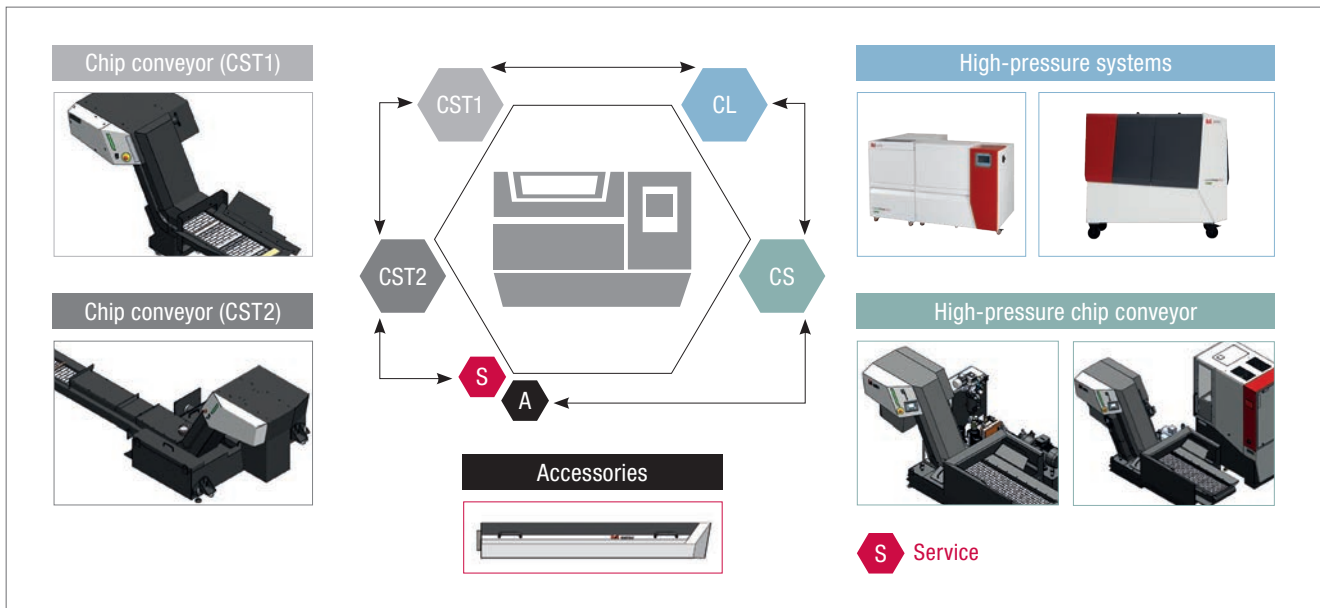

Müller x STAR Micronics represents development standards and unique customization options through a sophisticated modular system. This collaboration ensures precise adaptation of high-pressure systems to lathes, offering significant benefits in connectivity, operation and service.

~3h

for connection and
commissioning incl.
hose packages

15%

faster training
thanks to
standardization

+20%

efficiency with
a precise interface
fit

i4.0

Surveillance sensors,
tele-assistance and
remote maintenance-
ready

Maximize your efficiency and save thousands of euros in minutes!

Discover the Müller Configurator now: in just 12 easy steps to the perfect high-pressure system for your lathe. End oversizing and efficiency losses!

Use our innovative configurator to enhance your machine tools' performance by thousands of euros. Simple, fast, and precise - tailored specifically to your needs.

For the best machine configuration, scan the QR code and configure your optimal solution now!



Chip conveyors: Range and technical data

Chip conveyor
chipstream CST1

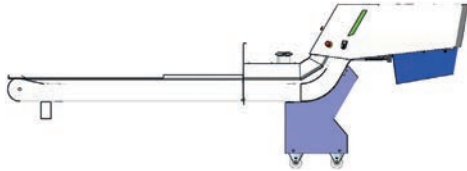

Chip conveyor with additional tank
chipstream CST2

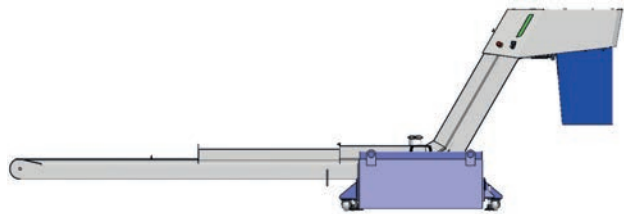

High-pressure chip conveyor
combistream CS3

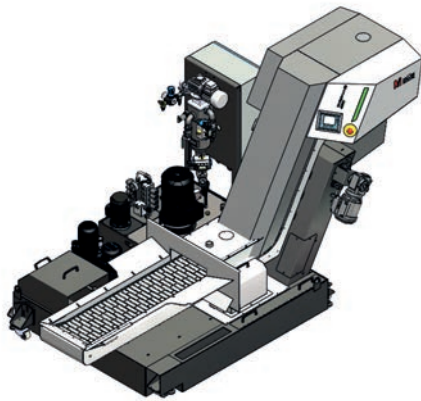

High-pressure chip conveyor with full-flow filtration
combistream CS4

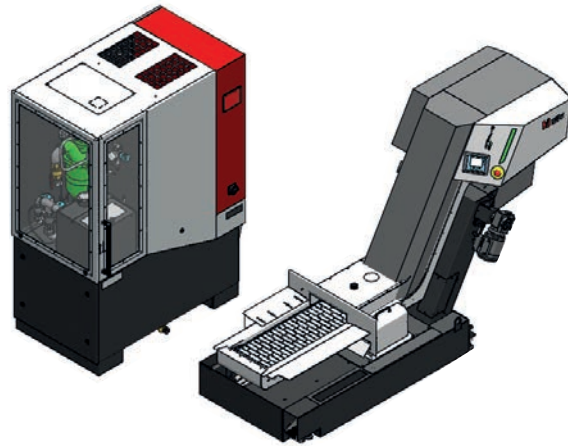

BK10 / BK11



BK20



BK30 / BK31

*BK11 / BK31: Scraper belt conveyor (not shown) instead of the hinged belt conveyor

	BK10	BK11	BK20	BK30	BK31
Function	Hinge belt conveyor with slot/plate division	Scraper conveyor with 500 µm pre-separation	Dual conveyor with 500 (300) µm pre-separation and automatic discharge	Hinge belt conveyor with slot/plate division and bottom cleaning of the machine tank	Scraper conveyor with 500 µm pre-separation and bottom cleaning of the machine tank
Construction	Configuration as a standard insert conveyor CST1 or in combination with CST2 or CS3	Configuration as a standard insert conveyor CST1 or in combination with CST2 or CS3	Pre-tank + Combo BK10 + Gap sieve 300 - 500 µm with discharge via dual conveyor	Replace machine tank; achieve maximum machine cleanliness via workspace conveyor and bottom cleaning	Replace machine tank; achieve maximum machine cleanliness via workspace conveyor and bottom cleaning
Application	Up to 30% fine chips max. (not recommended for brass, aluminium)	Fine chips only, max. 3-4 mm Ø roughing/rough machining. All materials.	Mixed chips: all chip types, all materials	Mixed chips: all chip types, all materials	Fine chips only, max. 3-4 mm Ø roughing/rough machining. All materials.

Star machine allocation

chipstream CST1	SB-12R	SB-16 III	SB-20R	SR-20J II	SR-20R IV	SR-32J III	SR-38	SD-26	SV-20R	SX-38	SW-12R II	SW-20	ST-20	ST-38
BK10	•	•	•	•	•	•		•	•		•	•		
BK11	•	•	•	•	•	•	•	•	•	•	•	•	•	•
Frequency-directed belt control														
chipstream CST2	SB-12R	SB-16 III	SB-20R	SR-20J II	SR-20R IV	SR-32J III	SR-38	SD-26	SV-20R	SX-38	SW-12R II	SW-20	ST-20	ST-38
BK10					•									
BK11														
BK20					•									
Integrated low-pressure supply														
Frequency-directed belt control					•									
Additional tank (as machine or pre-tank)					•									
combistream CS3	SB-12R	SB-16 III	SB-20R	SR-20J II	SR-20R IV	SR-32J III	SR-38	SD-26	SV-20R	SX-38	SW-12R II	SW-20	ST-20	ST-38
BK10	•		•	•	•	•	•	•	•	•		•	•	•
BK11														
BK20	•		•		•		•					•	•	•
BK30 + self-cleaning low-pressure intake protection	•		•	•	•	•	•		•			•		
BK31 + self-cleaning low-pressure intake protection	•		•											
Integrated high-pressure supply	•		•	•	•	•	•	•	•	•		•	•	•
Long parts version					•									
Integrated low-pressure supply	•		•	•	•	•	•	•	•	•		•	•	•
Additional tank (as machine or pre-tank)	•		•	•	•	•	•	•	•	•		•	•	•
eco+ maximum energy efficiency	•		•	•	•	•	•	•	•	•		•	•	•
Plate heat exchanger	•		•	•	•	•	•	•	•	•		•	•	•
combistream CS4	SB-12R	SB-16 III	SB-20R	SR-20J II	SR-20R IV	SR-32J III	SR-38	SD-26	SV-20R	SX-38	SW-12R II	SW-20	ST-20	ST-38
BK20														
BK30				•	•		•			•		•		•
BK31														
Long parts version														
Integrated full-flow filtration				•	•		•			•		•		•
Integrated high-pressure supply				•	•		•			•		•		•
Integrated low-pressure supply				•	•		•			•		•		•
Additional tank (as machine or pre-tank)				•	•		•			•		•		•
eco+ maximum energy efficiency				•	•		•			•		•		•
Plate heat exchanger				•	•		•			•		•		•
Active cooler				•	•		•			•		•		•

High-pressure systems: Range and technical specifications

	CL1	CL2	CL3	CL4
<p>Particularly tight installation spaces</p> 	 	 	 	
<p>Standard installation</p> 	 	 	 	 

	CL1B	CL1G	CL1E	CL2G	CL2E	CL3G	CL3E	CL4G
Washable exchange filter up to 25 µm	•	•	•	•	•	•	•	•
Twin coupling filter washable as exchange filter up to 25 µm	•		•	•	•	•	•	•
Washable cascade filter up to 25 µm						•		•
Automatic filter up to 30 µm						•	•	•
Pure high-pressure filtration	•	•	•	•	•	•	•	•
High-pressure and bypass filtration						•	•	•
Full-flow filtration								•
Up to 4 controllable service connections		•	•					
Up to 8 controllable service connections				•	•		•	
Up to 12 controllable service connections						•		•
High-pressure up to 24 l/min	•	•	•	•	•	•	•	•
High-pressure up to 30 l/min	•					•	•	
High-pressure up to 50 l/min	•					•		•
High-pressure up to 25 bar	•	•	•	•	•	•	•	•
High-pressure up to 70 bar		•	•	•	•	•	•	•
High-pressure up to 100 bar				•	•	•	•	•
High-pressure up to 150 bar						•	•	•
High-pressure up to 300 bar						•	•	•
Integrated tank up to 50 litres					•			
Integrated tank up to 200 litres				•			•	
Integrated tank up to 300 litres						•		
Integrated tank up to 800 litres								•
Under bar feeder positioning			•		•		•	
eco+ maximum energy efficiency			•	•	•	•	•	•
Plate heat exchanger (for external cooling source connection)						•	•	•
Compact active cooler (5.5 / 7.5 / 12.0 kW)								•

M

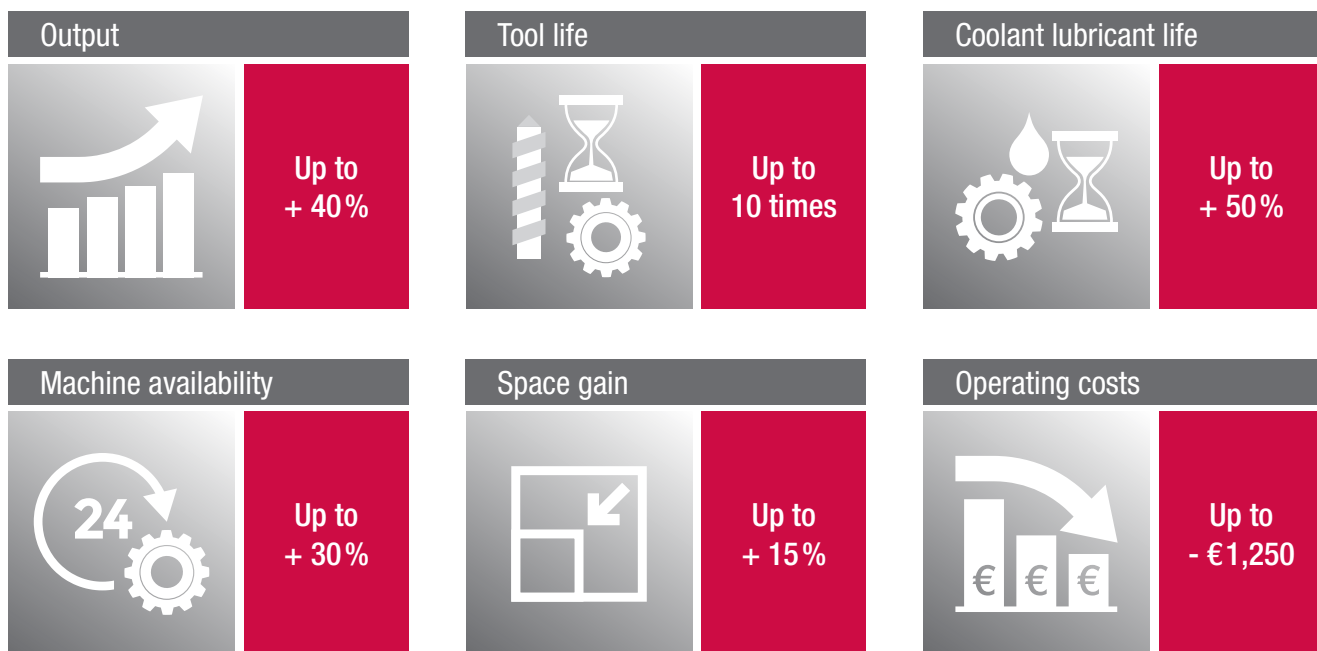

For more information on our benefits, please visit www.muellerhydraulik.de/en or scan the QR code.

Müller x Star Micronics – Contact



Müller Hydraulik GmbH
 Albring 29
 D-78658 Zimmern o. R.
 Phone +49 (0)741 / 174 575-0
 Fax +49 (0)741 / 174 575-299
sales@muellerhydraulik.de

HELP-DESK

Our help desk will be happy to assist you with support and service enquiries.

Phone +49 (0)741 / 174 575-121
service@muellerhydraulik.de

TICKET-SYSTEM

You can use our ticket system to report your service case online.

For this, please scan the QR code.



STAR Micronics GmbH
 Robert-Grob-Str. 1
 75305 Neuenbürg
 Phone +49 (0)7082 / 7920-0
 Fax +49 (0)7082 / 7920-20
info@starmicronics.de

